

MOTOR ROTAX DD2

SCHALTUNG - LENKRADNABE - **ALTES MODELL**

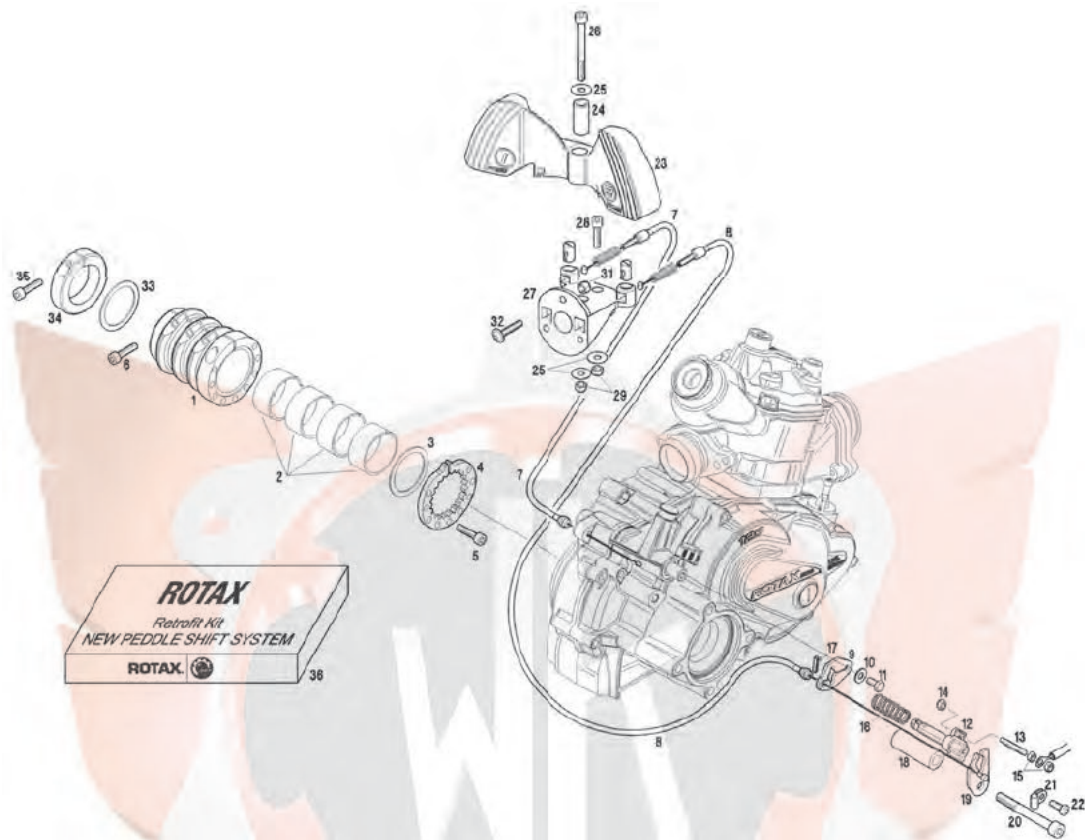

| | | | | |
|----|----------|--|--|---------------------------------|
| 1 | RX659393 | Antriebsflansch Klemmhülse | COUPLING FLANGE | Flasque d'embrayage |
| 1 | RX659398 | Antriebsflansch komplett | COUPLING FLANGE ASSY. | Kit flasque d'embrayage complet |
| 2 | RX233120 | Lagerhülse 40x44x20mm | PLAIN BEARING 40x44x20mm | Douille 40x44x20mm |
| 3 | RX626340 | Anlaufscheibe 41,5x50x1,5mm (Restposten) | THRUST WASHER 41,5x50x1,5mm | Rondelle 41,5x50x1,5mm |
| 4 | RX659383 | Antriebsflansch Zahnscheibe | CLUTCH HUB | Moyeu d'embrayage |
| 5 | RX640690 | Inbusschraube M6x25mm für Zahnscheibe | ALLEN SCREW M6x25mm | Vis BTR M6x25mm |
| 6 | RX840861 | Inbusschraube M6x25mm | ALLEN SCREW M6x25mm | Vis BTR M6x25mm |
| 7 | RX297132 | Seilzug 2.Gang kompl. | CABLE BOWDEN ASSY. 2ND GEAR | Kit gaine 2ème vitesse complet |
| 8 | RX297130 | Seilzug 1.Gang kompl. | CABLE BOWDEN ASSY. 1ST GEAR | Kit gaine 1ère vitesse complet |
| 9 | RX251406 | Halteblech (Schaltkontakt) | RETAINING PLATE | Support de gaine |
| 10 | RX845020 | Federscheibe M6 | SPRING WASHER M6 | Rondelle d'arrêt M6 |
| 11 | 4 1 | SK-Schraube M6x12mm Halteblech Schaltkontakt | HEX. SCREW M6x12mm | Vis TH M6x12mm |
| 12 | 6 31 | Schaltkontakt alt (Restposten) | SHIFT CONTACT - OLD MODEL | Contact de couplage - modèle |
| 11 | 6 33 | Schaltkontakt | SHIFT CONTACT | Contact de couplage |
| 13 | 0 1 | Gewindestift M5x30mm | ADJUSTMENT SCREW M5x30mm | Goujon M5x30mm |
| 14 | 4 5 | Sicherungsmutter M5 hoch | LOCK NUT M5 HEAVY TYPE | Écrou nylstop M5 haut |
| 15 | 4 1 | Mutter M5 | HEX.NUT M5 | Écrou M5 |
| 16 | 0 | Druckfeder Schaltung | COMPRESSION SPRING | Ressort pression 11,3x1,4x59 |
| 17 | 3 | Spannhülse 4x6mm rostfrei (Restbestand) | SLOTTED SPRING PIN 4x16 | Douille de serrage 4x16mm |
| 18 | 4 2 | Distanzrohr 10x18x49,5mm Schaltkontakt | SPACER 10x18x49,5mm | Douille 10x18x49,5mm (cont. |
| 19 | 1 | Schaltkontaktführung | SHIFT CONTACT GUIDANCE | Guide contact de couplage |
| 20 | RX841991 | Inbusschraube M8x70mm | ALLEN SCREW M8x70mm | Vis BTR M8x70mm |
| 21 | RX851117 | Rohrschelle 7mm (Schaltung) | CLAMP 7mm | Collier caoutchouté 7mm |
| 22 | RX841971 | Plastite-Schraube 5,5x16mm (Schaltung) | PLASTITE SCREW 5,5x16mm | Vis PLASTITE M5,5x16mm |
| 23 | RX660590 | Schaltwippe (Kunststoff) | SHIFT PADDLE | Bascule levier de vitesse |
| 24 | RX247380 | Distanzrohr 6,1x14x34,9mm | SPACER 6,1x14x34,9mm | Douille 6,1x14x34,9mm |
| 25 | RX827307 | Scheibe 6,2x18x0,5mm | WASHER 6,2x18x0,5mm | Rondelle 6,2x18x0,5mm |
| 26 | RX241261 | Inbusschraube M6x65mm | ALLEN SCREW M6x65mm | Vis BTR M6x65mm |
| 27 | RX660640 | Lenkradaufnahme | STEERING WHEEL SUPPORT | Moyeu de volant |
| 28 | RX840880 | Inbusschraube M6x30mm | ALLEN SCREW M6x30mm | Vis BTR M6x30mm |
| 29 | RX842040 | Mutter M6 selbstsichernd | LOCK NUT M6 | Écrou nylstop M6 |
| 31 | RX842046 | Mutter M6-8 selbstsichernd | LOCK NUT M6-8 | Écrou nylstop M6-8 |
| 32 | RX440761 | Linsenkopfschraube M6x20mm | ALLEN SCREW W. ROUNDED FLANGE HEAD M6x20mm | Vis BHC M6x20mm |
| 33 | RX427280 | Anlaufscheibe 40x50x1,5mm (Kupplungsflansch) | THRUST WASHER 40x50x1,5mm | Rondelle 40x50x1,5mm |
| 34 | RX251740 | Stellring 40mm (Schaltung) | CLAMPING RING 40mm | Bague de serrage 40mm |
| 35 | RX840861 | Inbusschraube M6x25mm | ALLEN SCREW M6x25mm | Vis BTR M6x25mm |
| 36 | RX281850 | Schaltwippe komplett „Neues System“ | RETROFIT KIT NEW PADDLE SHIFT SYSTEM | Kit changement couplage |